



Broadhurst Gardens NW6

Parkheath  
*Sold on Service*





## Broadhurst Gardens, NW6

### £430,000

### Leasehold

- Two bedroom split level maisonette
- 753 sq ft / 69.96 sq m
- Large eat-in separate kitchen
- Bright 15' reception room
- 2 good sized double bedroom with fitted storage
- Excellent South Hampstead conservation area location
- Perfect first time buy or investment property
- 4 minute walk to Finchley road station (Jubilee and Metropolitan lines)
- Short walk to all amenities of West End Lane, Finchley Road and Swiss Cottage
- Chain free

Belsize Park/Hampstead  
208 Haverstock Hill  
NW3 2AG  
Sales 020 7431 1234  
Lettings 020 7431 3104  
[nw3@parkheath.com](mailto:nw3@parkheath.com)

South/West Hampstead  
192 West End Lane  
NW6 1SG  
Sales & Lettings  
Tel 020 7794 7111  
[192@parkheath.com](mailto:192@parkheath.com)

Kensal Rise  
54-56 Chamberlayne Rd  
NW10 3JH  
Tel 020 8960 4845  
[kensal@parkheath.com](mailto:kensal@parkheath.com)

Property Management  
192 West End Lane  
NW6 1SG  
020 7433 6174  
[pm@parkheath.com](mailto:pm@parkheath.com)

**Parkheath**  
*Sold on Service*

**Camden Tax band B**

[www.parkheath.com](http://www.parkheath.com)

Broadfield,  
Broadhurst Gardens, NW6

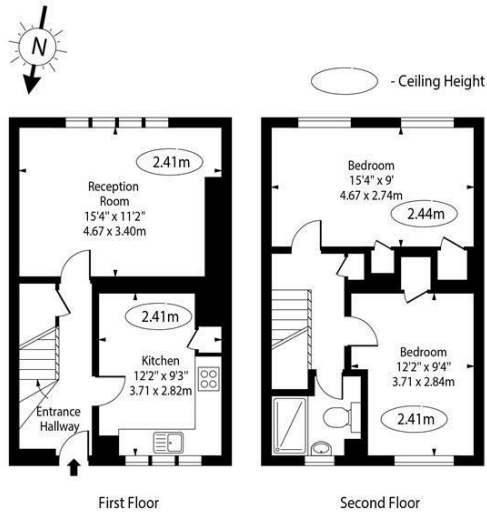

Approx Gross Internal Area 753 Sq Ft - 69.96 Sq M

For Illustration Purposes Only - Not To Scale Floor Plan by [www.nogaphotostudio.com](http://www.nogaphotostudio.com) Ref: No.49778  
This floor plan should be used as a general outline for guidance only. Any intending purchaser or lessee should satisfy themselves by inspection, searches, enquiries and full survey as to the correctness of each statement. Any areas, measurements or distances quoted are approximate and should not be used to value a property or be the basis of any sale or let.

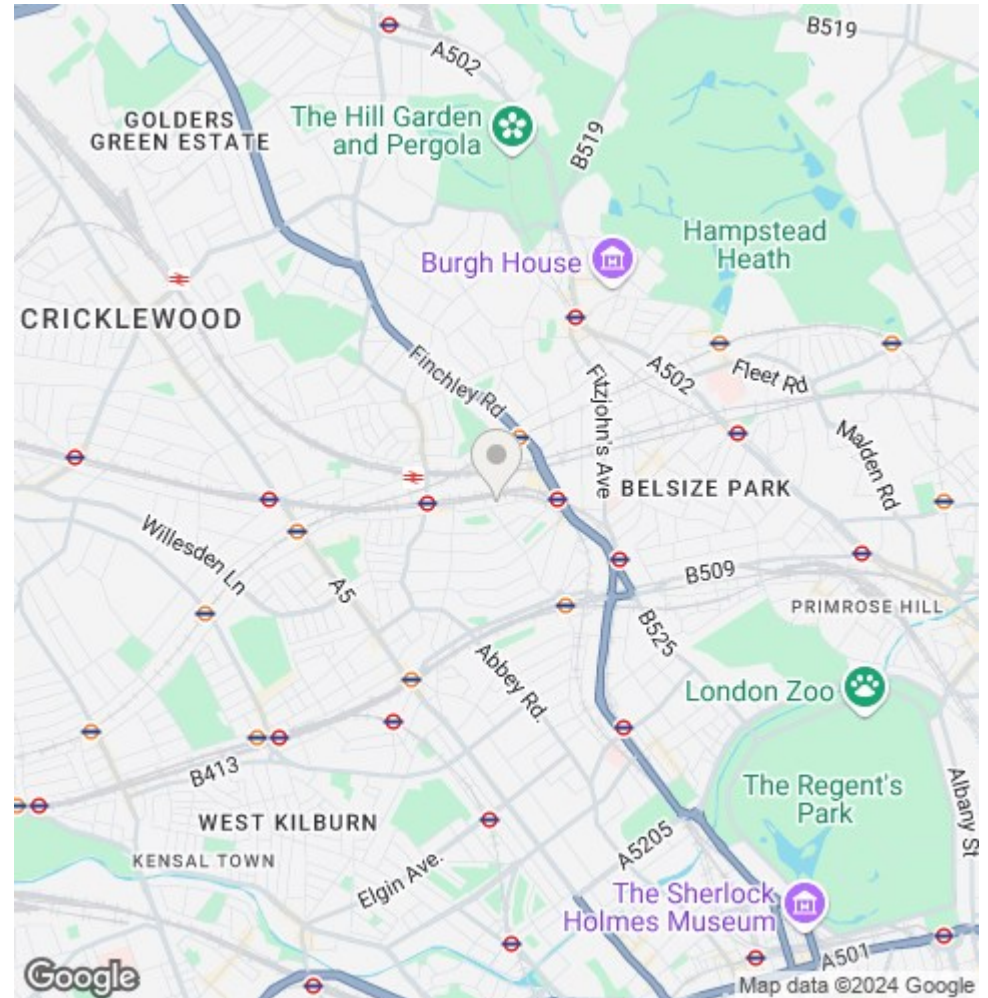

The particulars do not constitute part of an offer or contract. The particulars, including text, photographs and plans, are for the guidance only of prospective purchasers/tenants and must not be relied upon as statements of fact. The descriptions provided therein represent the opinion of the author and whilst given in good faith should not be construed as statements of fact. Nothing in these particulars shall be deemed a statement that the property is in good condition or otherwise or that any services or facilities are in good working order. All measurements are approximate